

11-229/12

Bi

11-229/14

polbruk

229/13

101.77  
11-230/1

Mickiewicza

11-283/1  
m2  
11-283/1;1  
104.94

h

11-283/2

11-282/2;2  
t  
11-283/2;2

PKP

11-284/3  
11-284/4

10-105;1

110.90  
10-105/2

k

10-185/53



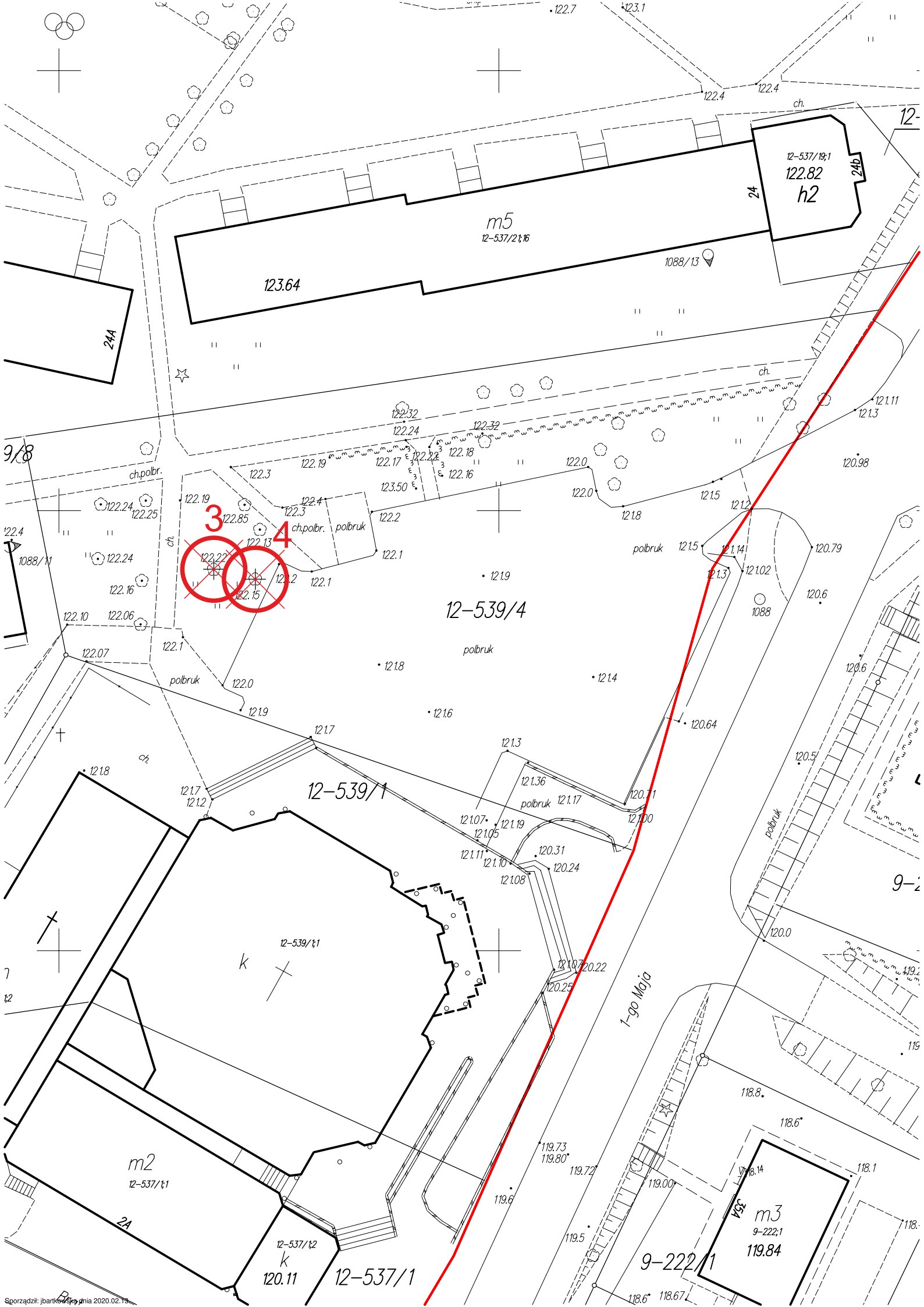

m5  
12-537/21;16  
123.64

12-537/19;1  
122.82  
h2  
24b

3  
4

12-539/4

12-539/1

m2  
12-537/1;1

m3  
9-222/1  
119.84

12-537/1

9-222/1

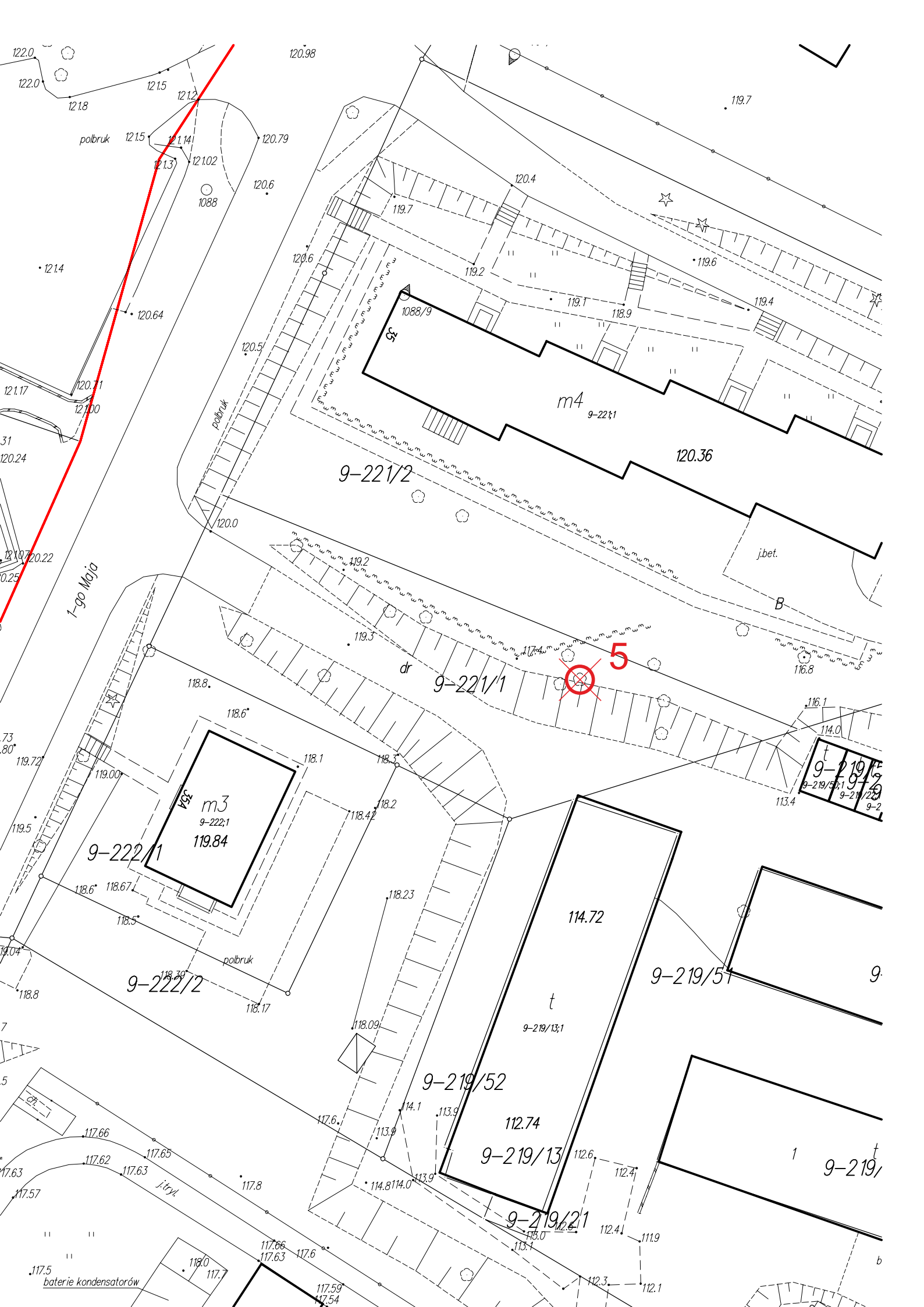

Ilawka →

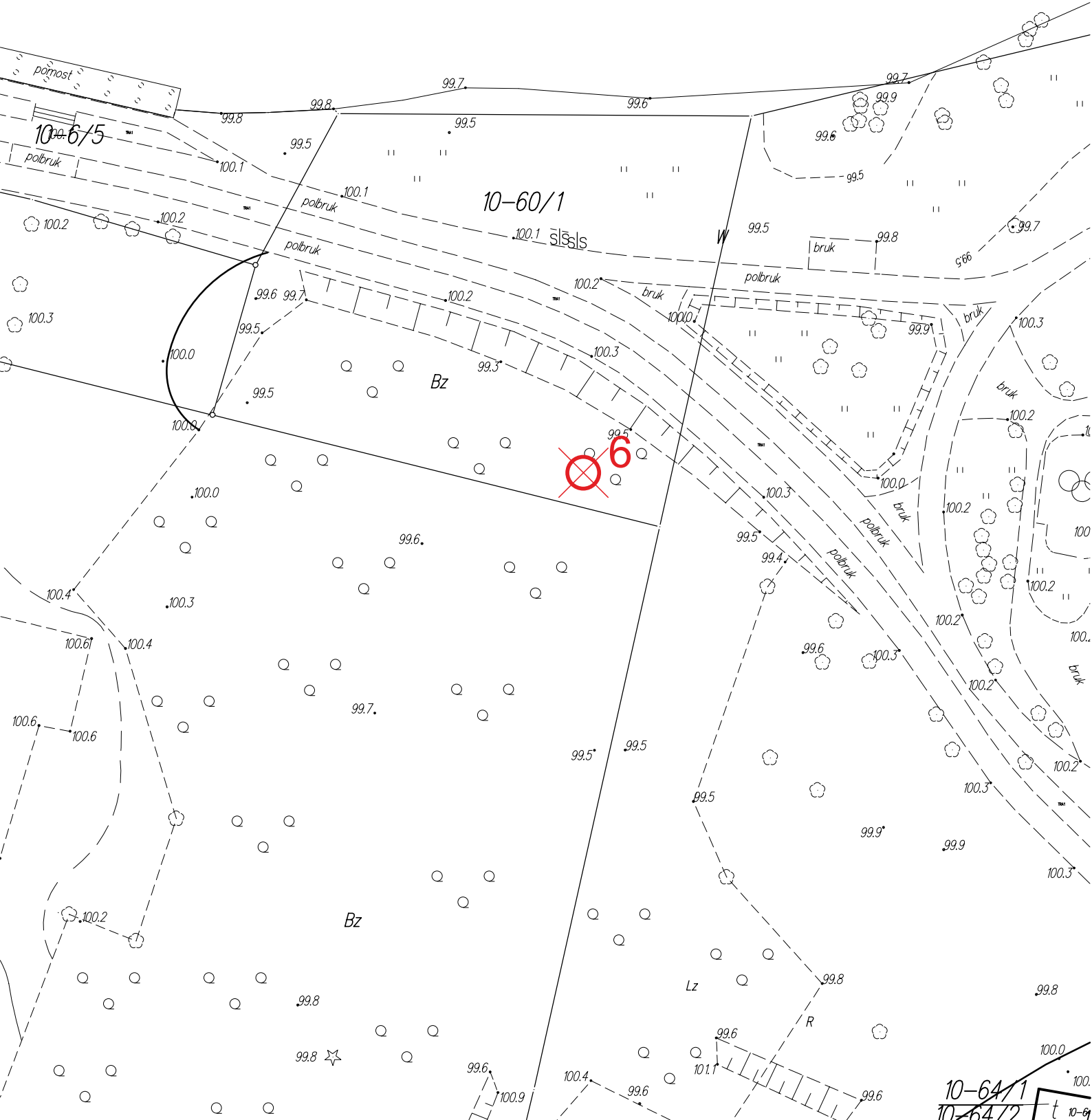

10-64/1  
10-64/2 t 10-9

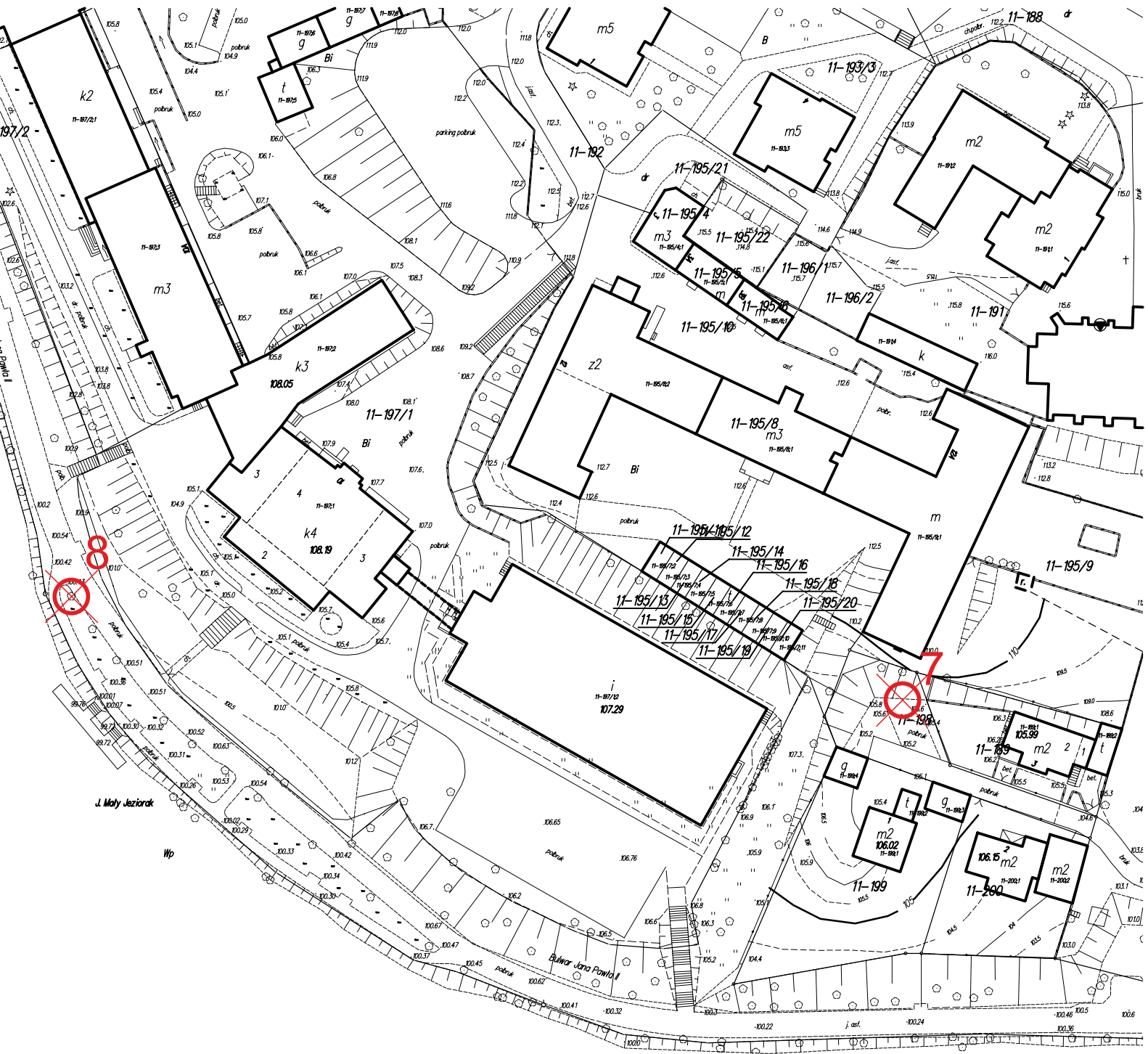

ty Jeziorak

.w=99.57  
2.03.2017

